

General Facts:

Year of Opening	2003
Total Retail GLA (m2)	20,900
No. Retail Units	116
Food Anchor	Albert
Parking Spaces	757

Demographics:

Population (2016)	1,276,741
-------------------	-----------

Regional Office:

For general enquiries: Atrium
 Czech Real Estate
 Management s.r.o
 Vinohradská 2828/151
 13000 Prague
 Czech Republic
 Tel: +420 255 724 011
 Fax: +420 255 724 010

Leasing Contact:

Petr Vondrášek
 pvondrasek@aere.com
 Tel: +420 255 724 042

Last Revision: 12-2016

Disclaimer

The information in this document has been compiled from in-house and/or external sources, is provided for information purposes only, is subject to change over time, and may not be relied upon by any third party.

Floorplan and Anchors

Floor GF

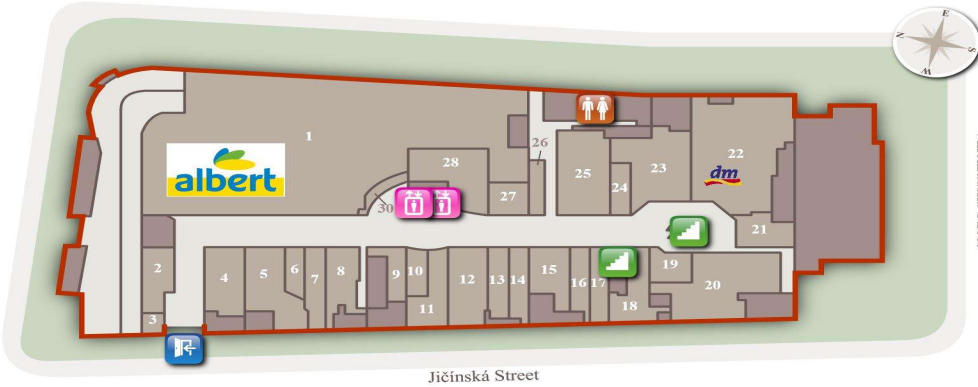

Floor 1

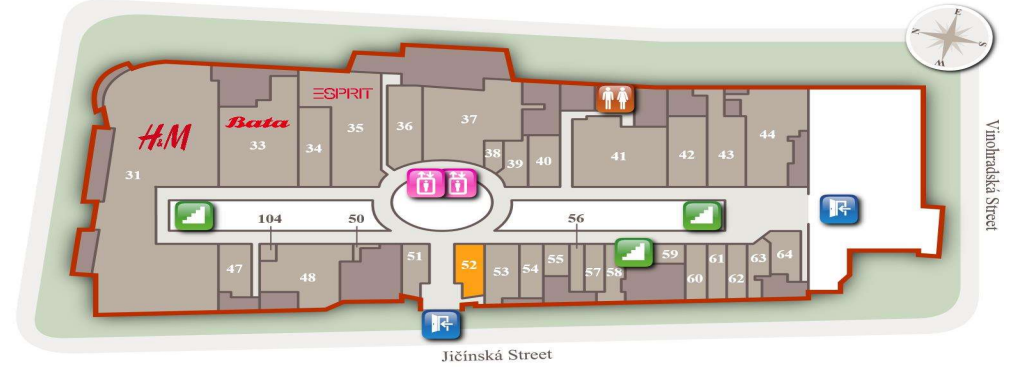

Floor 2

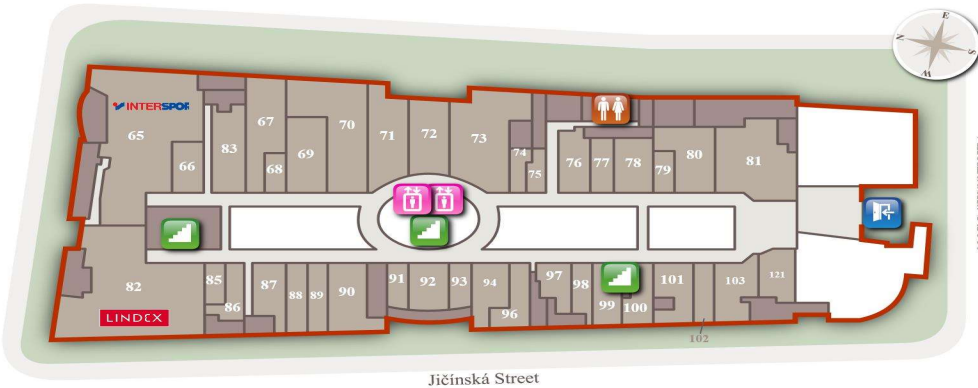

Floor 3

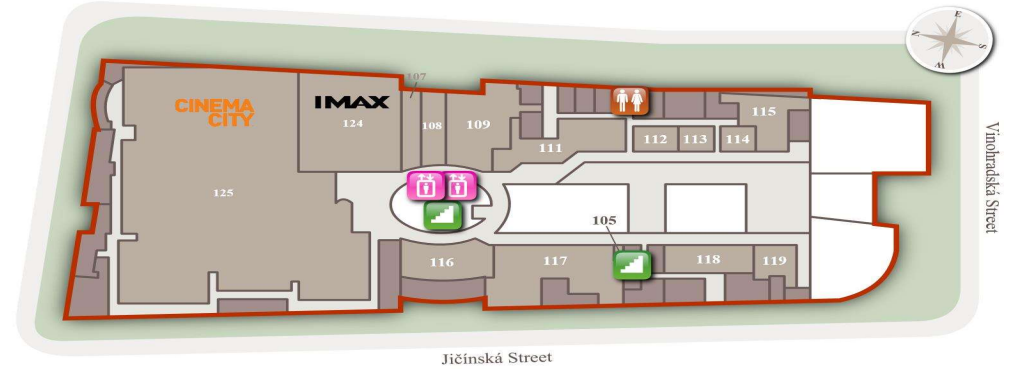

Top Tenants

125	(F0010007)	Cinema City	2,621 m ²	117	(F0010011)	Detaillo	348 m ²
1	(B0020001)	Albert	1,840 m ²	109	(F0010024)	Bombay Express	338 m ²
31	(B0010048)	H&M	1,204 m ²	41	(B0010010)	Camaieu	312 m ²
124	(F0010006)	Imax	751 m ²	73	(GRFL0007)	A3 sport	302 m ²
82	(GRFL0065)	Lindex	670 m ²	20	(B0020005)	Bambule	289 m ²
65	(GRFL0001)	Intersport	572 m ²	44	(B0010013)	Promod	278 m ²
22	(B0020003)	DM	472 m ²	70	(GRFL0003)	Butlers	278 m ²
33	(B0010002)	Bata	373 m ²	81	(GRFL0014)	Sephora	272 m ²
35	(B0010003)	Esprit	366 m ²	111	(F0010001)	McDonalds	250 m ²
37	(B0010006)	Fann Parfumerie	352 m ²	23	(B0020002)	Paul	236 m ²

Vacancies

52 - 76 m²

Last Revision: 12-2016

Disclaimer

The information in this document has been compiled from in-house and/or external sources, is provided for information purposes only, is subject to change over time, and may not be relied upon by any third party.